

PRESS FITTINGS FOR PEX-AL-PEX PIPES

# DOUBLE FLANGED FITTINGS WITH PARALLEL WAYS

4059

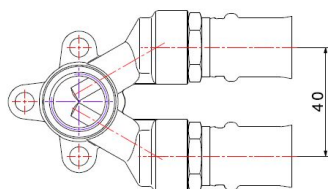
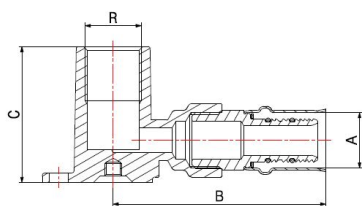
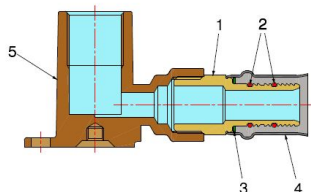

- Flanged female fitting with parallel double ways
- Maximum operating pressure 10 bar
- Temperature range min 0°C - max +95°C
- The jaws for the fittings pressing have to be **TH** profile.

Fitting suitable for distributing fluids that are generally non-corrosive, compatibly with the fitting materials. Heating, plumbing and industrial systems are the ideal fields of application, such as high and low temperature heating systems, air-conditioning and distribution of drinking water. The tightness is guaranteed by two EPDM PEROX O-Rings, particularly recommended with water-glycol solutions, with a maximum glycol presence of 50%. The steel sleeve pressing, carried out with electromechanical tools, ensures a perfect and indivisible crimping to the pipe as well as an excellent resistance to external stress.

### COMPONENTS

POS.	PART NAME	N°	MATERIAL
1	Fitting	2	CW617N UNI-EN 12164
2	O-Ring	4	EPDM Perox
3	Washer	2	PTFE
4	Bushing	2	AISI 304 stainless steel
5	Flanged body	1	CW617N UNI-EN 12165

### DIMENSIONS

A	R	B	C
16	1/2"	75	50
20	1/2"	75	50

### PACKAGING

	16 - 1/2"	20 - 1/2"
<b>CODE</b>	<b>40591604</b>	<b>40592004</b>
PCS BAG	5	5
PCS CARTON	50	50